

- NOTES
1. FOR STRUCT STEEL GEN. NOTES REF. H-3-20198
 2. ALL BEAM CONN. TO BE STD. AISC SERIES B UNLESS NOTED OTHERWISE
 3. ALL BEAM CONN. TO BE MADE W/HIGH STRENGTH BOLTS
 4. FOR CONC. GEN. NOTES REF. H-3-20198

H-3-20264 1

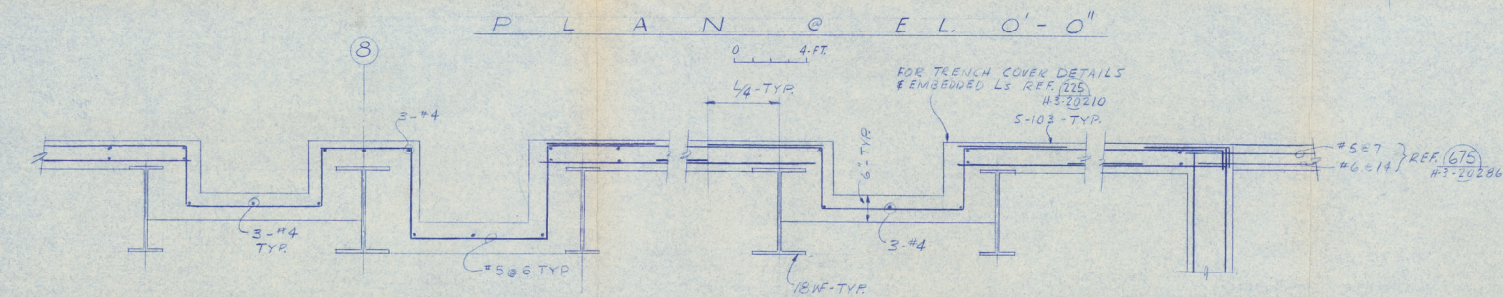

CHECK PRINT DATE: _____ ISSUE NO.: _____		COMMENT PRINT DATE: _____ ISSUE NO.: _____		APPROVED FOR CONST. BY: _____ DATE: _____		APPROVED FOR PURCHASE BY: _____ DATE: _____			
H-3-20208 STR CONC SLAB SCH. & DETS H-3-20209 SPECIFICATIONS SK-3-1073 DRAWING L.T. (DES. CHG. #2) H-3-20263 BAS'T PLAN (DES. CHG. #2) H-3-20200 PLAN @ 0'-0'-AREA 3 H-3-20198 PLAN @ 0'-0'-AREA 1				SCALE SHOWN DRAWN BY: G. GUNN CHECKED BY: _____ DATE: _____				APPROVED FOR DESIGN BY: _____ DATE: _____	
1 CHECKED FOR AS BUILT 2 WAS 10'-9" IN. P.		EAO 3-24-66	GAG REC	SEC 4/1/66	REF. NO. DWG. NO.	DRAWING TITLE REFERENCE DRAWINGS	PROJECT NO. 5-20153		
REVISIONS		REV. BY DATE	APP'D BY	FOR	DATE	CLASSIFIED BY DATE	CLASSIFICATION NONE		
U. S. ATOMIC ENERGY COMMISSION VITRO ENGINEERING CO. A DIVISION OF VITRO CORP. OF AMERICA RICHLAND OPERATIONS OFFICE				STRUCTURAL PLAN @ EL. 0'-0" AREAS 1 & 3 DESIGN CHANGE #2 FUELS RECYCLE PILOT PLANT					
SHEET NO. 324				INDEX NO. 0900-1000					
H-3-20264				SHEET NO. 1					